



MOTORCYCLE EQUIPMENT

[www.mdi-online.nl](http://www.mdi-online.nl)

**MDI MOTORCYCLE EQUIPMENT**

De Hammen 30  
5371 MK Ravenstein  
The Netherlands

Phone : +31(0)486 - 41 53 30  
Fax : +31(0)486 - 41 13 75  
Mail : [info@mdi-online.nl](mailto:info@mdi-online.nl)  
Web : [www.mdi-online.nl](http://www.mdi-online.nl)

BTW nr. : NL 812539540B01  
K.v.K. nr. : 17159355

Schafer, Hans

**FACTUUR**

Factuur nr.: 2128577

Datum: 08-12-2012

Artikel nr.	Artikel	Aantal	Prijs per stuk	Totaalprijs
MDI-Z9401A	Armsteun passagier (BMW K1200LT)	1	349,00	349,00

Subtotaal	Porto / Verpakkingskosten	BTW%	BTW Bedrag	Eindtotaal incl. BTW
288,43	0,00	21%	60,57	€ 349,00



**INSTALLATION AND OWNER'S MANUAL**  
Z9401A Passenger Arm Rests for the K1200 LT

Before proceeding with the installation carefully read the instructions and consider whether one possesses the necessary technical skills and workshop tools to complete the installation properly. Otherwise, any BMW Motorcycle Retailer will be glad to install this accessory.

**Attention**



Special notes and cautionary measures which can prevent damage to the accessory or motorcycle.

**Note:**



Tips for facilitation of operation, control and adjustment, as well as maintenance work.

**PARTS LIST**

Index	Description	Part No.	Qty.
1	Pad	70-730052-000	2
2	Stay, Left	70-740012-000	1
3	Stay, Right	70-740013-000	1
4	Arm Rest, Left	70-740014-000	1
5	Arm Rest, Right	70-740015-000	1



These Passenger Arm Rests fit to the left and right sides of the rear trunk lid of the K1200LT. Use the enclosed template for a drilling guide.

Left and Right side of motorcycle are determined while seated on the bike.

**BAG 409 A**

6	Screw, Flat, M6 x 16 Stainless	51-514217-000	2
7	Screw, Flat, M6 x 18 Stainless	51-514218-000	2
8	Screw, Flat, M6 x 25 Stainless	51-514227-000	4
9	Screw, Hex, M6-1.0 x 20	51-515324-000	6
10	Screw, Hex, M8 x 35	51-515737-000	2
11	Nut Hex M6-1.0 JAM	42-423044-000	2
12	Nut Hex M6-1.0 w/Nylok Patch	42-423040-000	2
13	Gasket	75-763202-000	2
14	Washer, Flat Nylon	49-490211-000	2
15	Support Brace	37-370748-000	2
16	Nut Plate	37-370749-000	2
17	Washer, Flat Stainless	49-490301-000	2
18	Bushing, L .630"	49-495505-000	2

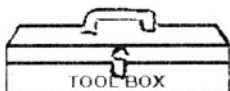
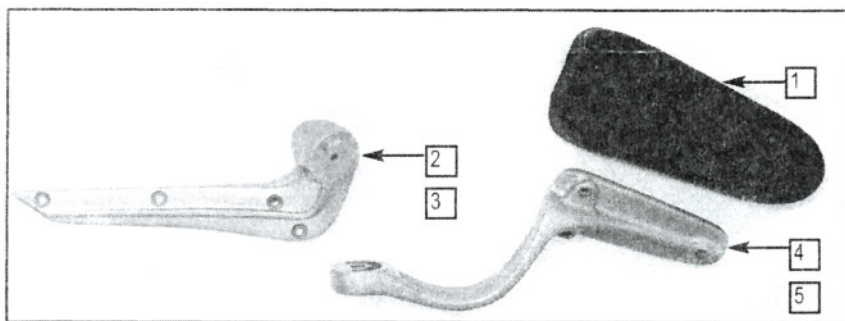
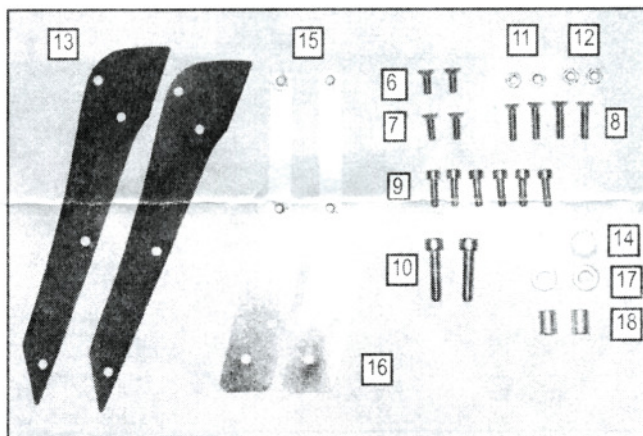

**Tools Needed:**

- Flat Blade Screwdriver
- Scissors (for template)
- Cellophane Tape
- Hand Drill with 1/4" (6.5mm) Drill Bit
- 6mm, 5mm and 4 mm Hex Key Wrench

**ZTechnik** PO Box Maywood, IL 60153-0158 USA

708-343-0400 / Fax: 708-343-0625 / www.ZTechnik.com / e mail: info@ZTechnik.com

©2004 National Cycle, Inc.

Page 1 of 4

10-117806-000 Rev A 06/07